

BRIDGING SURFACES

The site is in DUMBO Brooklyn New York, specifically on Prospect Street between Adam's Street and Pearl Street. The building which the bridge is attached to was constructed in 1901. Formally the building was owned by the Jehovah Witness group, and now owned by Brooklyn Triangle Offices. Currently the building remains vacant except for few businesses that are occupying ground floor levels. This won't be for long as companies are moving to the upcoming area. The area itself is starting to develop as a point of interest for people due to its location being relatively close to Brooklyn and Manhattan bridge. The site itself stays true to DUMBO's acronym (Down Under the Manhattan Bridge Overpass) due to it being parallel to the Manhattan bridge.

The idea behind this project was to get in touch with your creative side to develop a work of abstract art. Through this process much of it was deriving inspiration to be creative. From start to end we see ideas seep throughout each phase of design, each inspired by the last. In the end the model reflects crude ideas polished to be an aesthetic work of art that stays true to its function.



CONCEPT DIAGRAMS

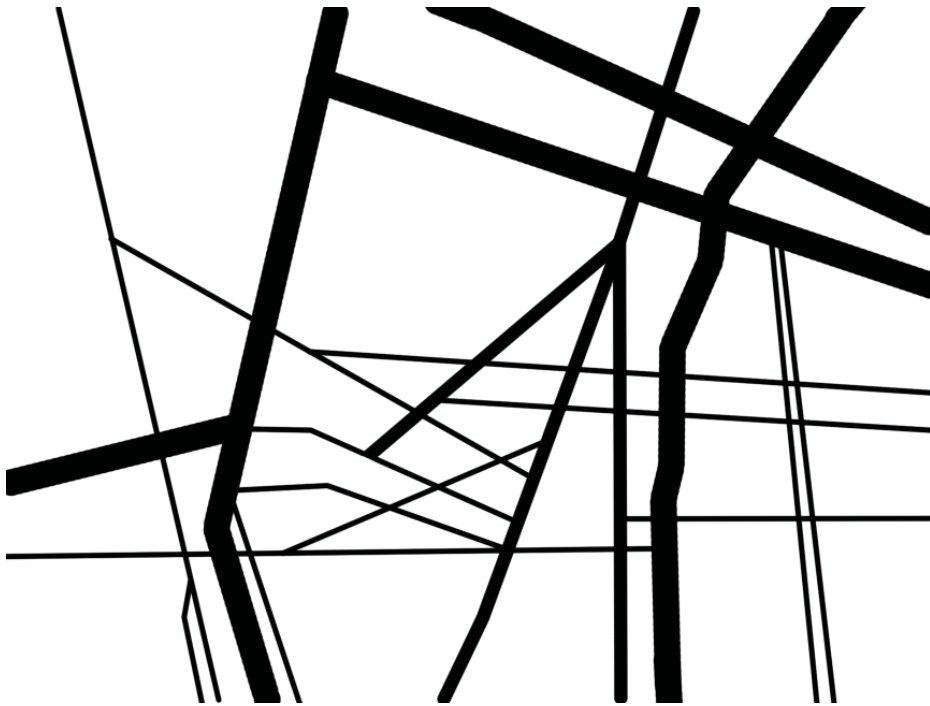

LINE DIAGRAMS



NULL & VOID DIAGRAM

Concept diagrams were extracted from the 2d sequence collage. This was composed in two parts, first the line diagram and then the mass and void diagram. For the line diagram my thought process behind this was to extract lines I thought were dominant in the collage. The more dominant I felt a line was the heavier the line weight was. The null diagram was a bit more difficult but instead of shading an entire building black I chose to extract dark colored areas from the collage.

STUDY MODELS

MODEL PHOTOS



LINE



PLANAR



VOLUMETRIC

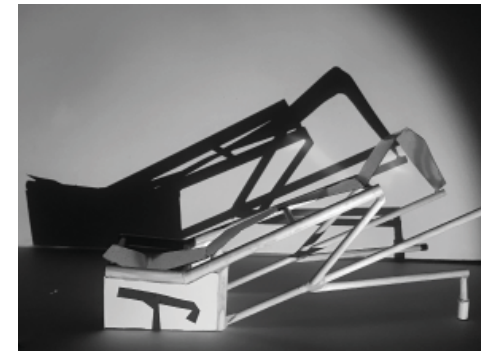

HYBRID

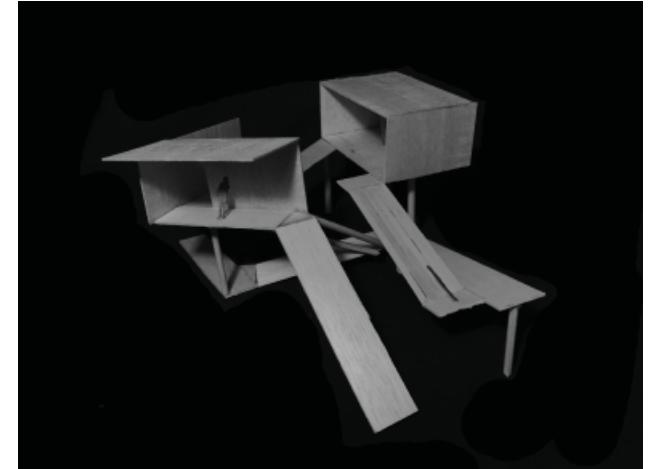
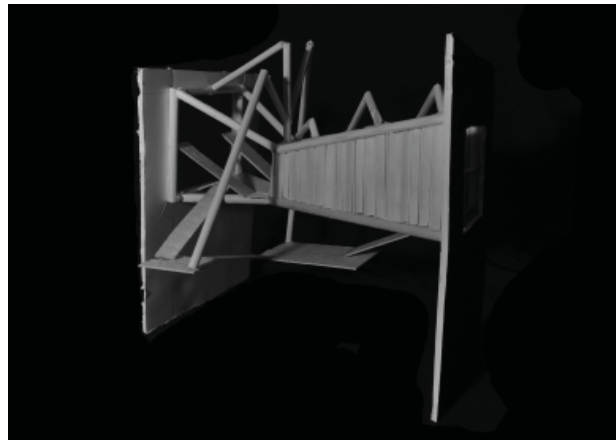
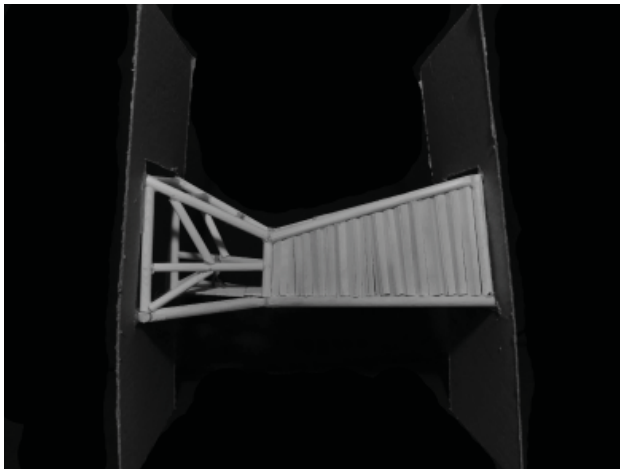

DESIGN STUDY INTERACTIONS

FINAL MODEL

INTERIOR PERSPECTIVES

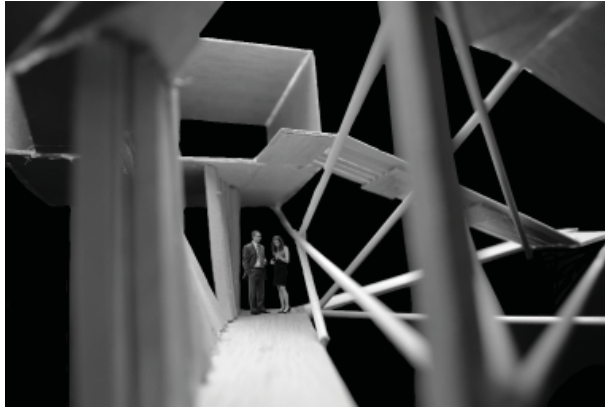

PHOTOMONTAGE



FINAL MODEL DRAWINGS

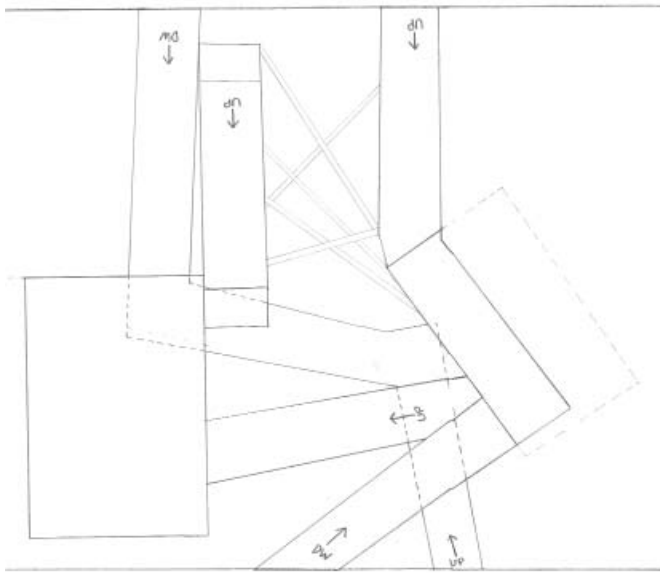

PLAN VIEW

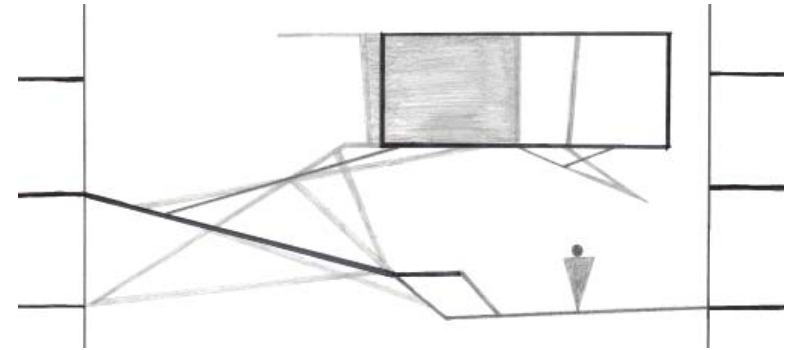

SECTION



TRANSVERSE SECTION

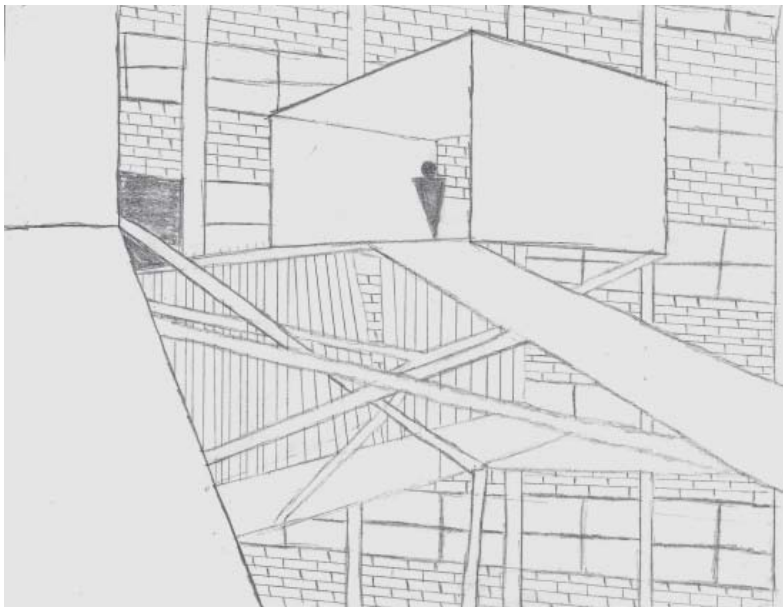

INTERIOR PERSPECTIVE

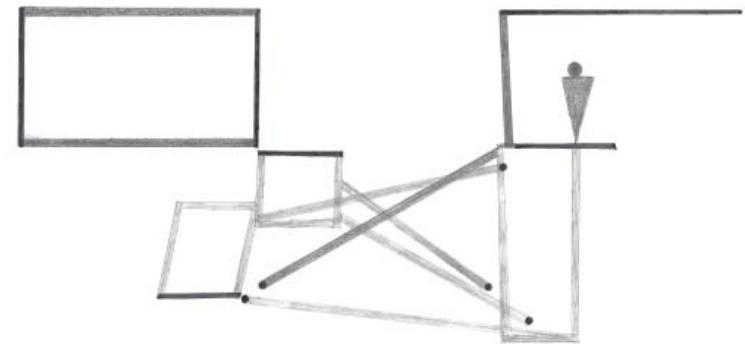

TRANSVERSE SECTION